

GS 1. – 08.09.2009.

1. a) Primjenom principa superpozicije nacrtajte M dijagram. U obzir uzmite utjecaj samo momenta $M = 150 \text{ kNm}$ u zglobu.
 b) Grafičkim postupkom odredite sile u poprečnom presjeku $t - t$

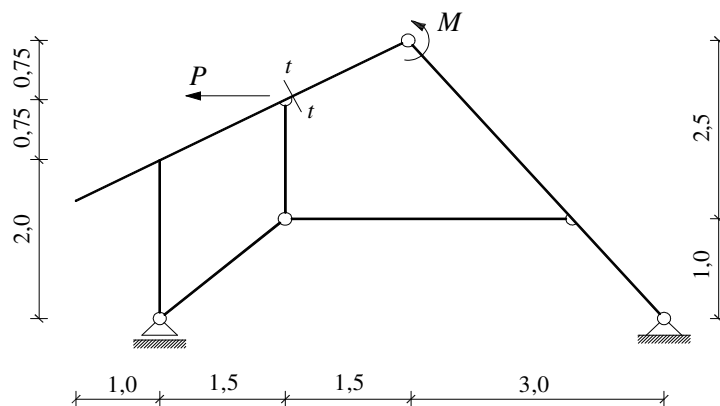

$$P = 120 \text{ kN}$$

$$M = 150 \text{ kNm}$$

2. a) Primjenom metode sila nacrtajte M dijagram.
 b) Odredite horizontalni pomak točke T.

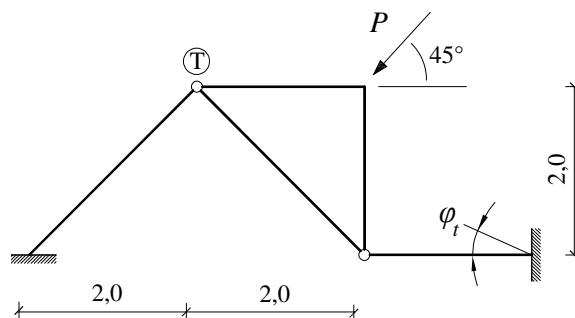

$$P = 100\sqrt{2} \text{ kN}$$

$$\varphi_t = 0,004$$

$$E = 3 \cdot 10^7 \text{ kN/m}^2$$

$$b/h = 35/45 \text{ cm}$$

3. Nacrtajte M i T dijagrame.

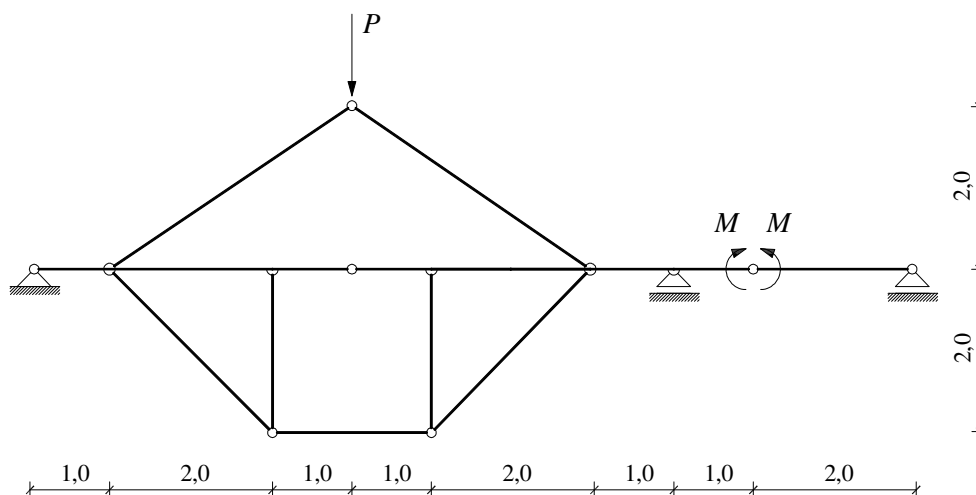

$$P = 100 \text{ kN}$$

$$M = 100 \text{ kNm}$$