

GS 1. – 12.02.2013.

1. Nacrtajte dijagrame unutarnjih sila.

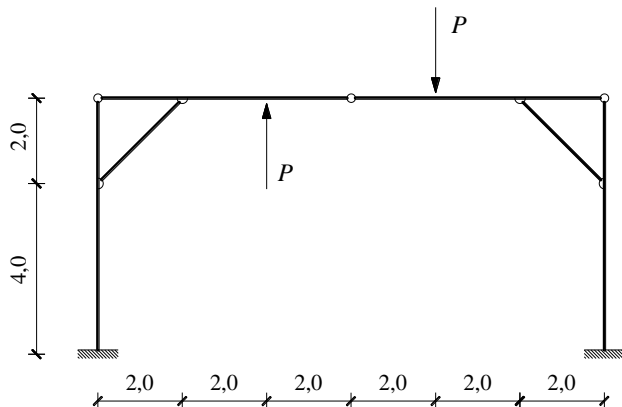

$$P = 100,0 \text{ kN}$$

$$E = 3,0 \times 10^7 \text{ kN/m}^2$$

$$b/h = 50/50 \text{ cm}$$

2. a) Za zadane sustave odredite dijagrame unutarnjih sila analitičkim postupkom.
b) Grafičkim postupkom provjerite vrijednosti sila presjecima $t-t$.

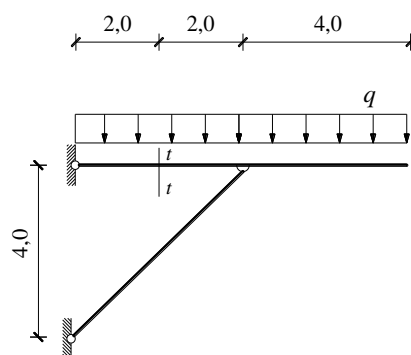
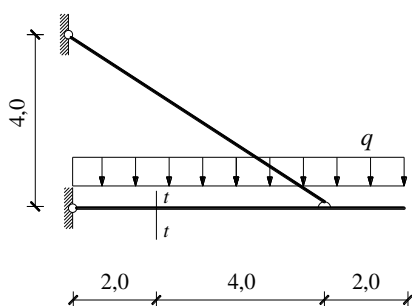

$$q = 10,0 \text{ kN/m'}$$

3. Može li se izračunati progib točke C? Ako može izračunajte ga! Ako ne može, zašto ne?

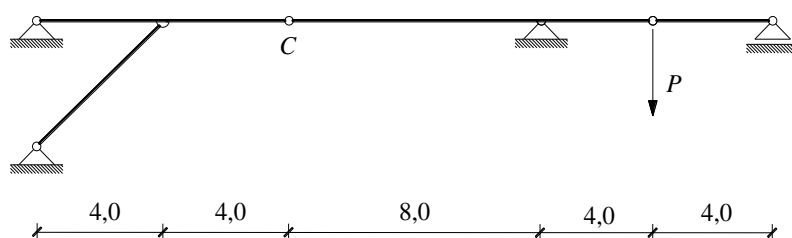

$$P = 200,0 \text{ kN}$$

$$E = 3,1 \times 10^7 \text{ kN/m}^2$$

$$b/h = 30/50 \text{ cm}$$